

SECCION 1.3 ACCESORIOS DE ENSAMBLE PARA CHAROLAS TIPO ESCALERA Y FONDO SOLIDO

SECTION 1.3 ASSAMBLY FITTING FOR CABLE TRAY SYSTEM LADDER AND SOLID BOTTOM TYPE

CONECTOR TIPO "Z"

FORM "Z" SPLICE PLATE

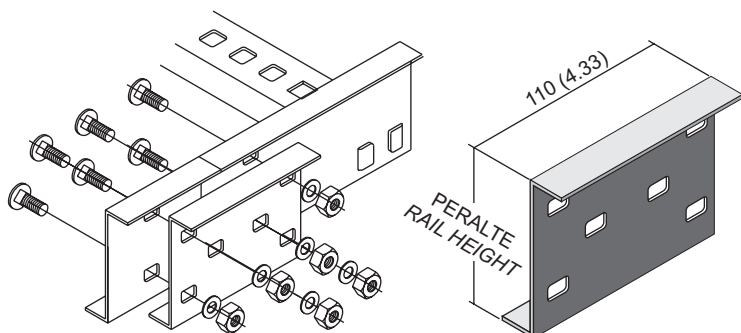

AZ-1GI

MATERIAL Y ACABADO (VER PAG 20)
 MATERIAL & FINISHES (SEE PAGE 20)
 SUBFIJO P/PERALTE (VER PAG 20)
 RAIL HEIGHT SUFFIX (SEE PAGE 20)
 CONECTOR TIPO Z FORM Z CONNECTOR

APLICABLE SOLO PARA PRODUCTOS PERFIL TIPO Z
 USE ONLY WITH PRODUCTS Z RAIL SIDE FORM

TORNILLERIA INCLUIDA
 HARDWARE INCLUDED

CONECTOR RECTO

STRAIGHT SPLICE PLATE

AR-1GI

MATERIAL Y ACABADO (VER PAG 20)
 MATERIAL & FINISHES (SEE PAGE 20)
 SUBFIJO P/PERALTE (VER PAG 20)
 RAIL HEIGHT SUFFIX (SEE PAGE 20)
 CONECTOR RECTO STRAIGHT CONNECTOR

TORNILLERIA INCLUIDA
 HARDWARE INCLUDED

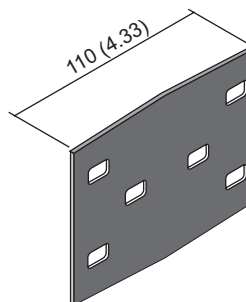

CONECTOR FORMA L

FORM "L" SPLICE PLATE

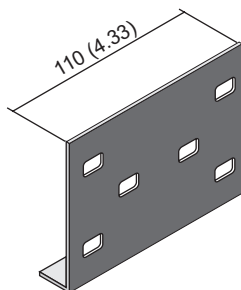

AL-1GI

MATERIAL Y ACABADO (VER PAG 20)
 MATERIAL & FINISHES (SEE PAGE 20)
 SUBFIJO P/PERALTE (VER PAG 20)
 RAIL HEIGHT SUFFIX (SEE PAGE 20)
 CONECTOR FORMA L FORM L CONNECTOR

TORNILLERIA INCLUIDA
 HARDWARE INCLUDED

CONECTOR DE EXPANSION

EXPANSION CONNECTOR

AE-1GI

MATERIAL Y ACABADO (VER PAG 20)
 MATERIAL & FINISHES (SEE PAGE 20)
 SUBFIJO P/PERALTE (VER PAG 20)
 RAIL HEIGHT SUFFIX (SEE PAGE 20)
 CONECTOR DE EXPANSION EXPANSION CONNECTOR

PARA UNA EXPANSION DE 25.4mm (1") FOR AN EXPANSION OF 25.4 mm (1")

NO INCLUYE CINTAS CONDUCTORAS BONDING JUMPERS NOT INCLUDED

TORNILLERIA INCLUIDA HARDWARE INCLUDED

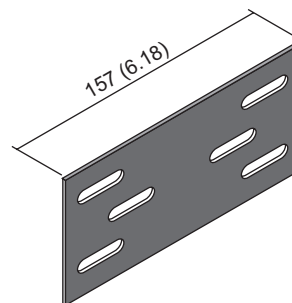

TODAS LAS DIMENSIONES EN mm (Pulg) ALL DIMENSIONS ARE IN mm (Inch)

ELEVADOR AJUSTABLE

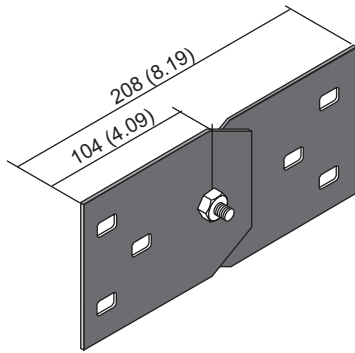

EA-1GI

- MATERIAL Y ACABADO (VER PAG 20)
- MATERIAL & FINISHES (SEE PAGE 20)
- SUBFIJO P/PERALTE (VER PAG 20)
- RAIL HEIGHT SUFFIX (SEE PAGE 20)
- ELEVADOR AJUSTABLE VERTICAL ADJUSTABLE CONNECTOR

NO INCLUYE CINTAS CONDUCTORAS BONDING JUMPERS NOT INCLUDED

TORNILLERIA INCLUIDA HARDWARE INCLUDED

VERTICAL ADJUSTABLE CONNECTOR

CONECTOR HORIZONTAL AJUSTABLE

AH-1GI

- MATERIAL Y ACABADO (VER PAG 20)
- MATERIAL & FINISHES (SEE PAGE 20)
- SUBFIJO P/PERALTE (VER PAG 20)
- RAIL HEIGHT SUFFIX (SEE PAGE 20)
- CONECTOR HORIZONTAL AJUSTABLE
- HORIZONTAL ADJUSTABLE CONNECTOR

NO INCLUYE CINTAS CONDUCTORAS BONDING JUMPERS NOT INCLUDED

TORNILLERIA INCLUIDA HARDWARE INCLUDED

HORIZONTAL ADJUSTABLE CONNECTOR

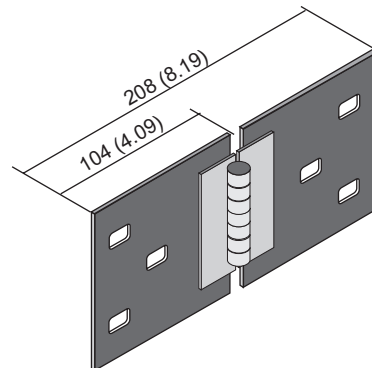

CONECTOR REDUCTOR

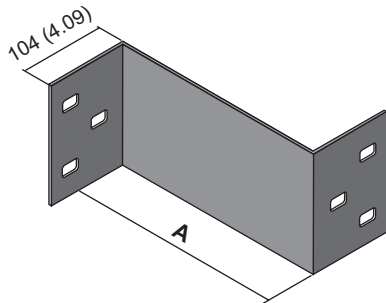

ARR-19.5-1GI

- MATERIAL Y ACABADO (VER PAG 20)
- MATERIAL & FINISHES (SEE PAGE 20)
- SUBFIJO P/PERALTE (VER PAG 20)
- RAIL HEIGHT SUFFIX (SEE PAGE 20)
- DIFERENCIA DE ANCHOS VER NOTA 1
- WIDTH DIFFERENCE SEE NOTE 1
- CONECTOR REDUCTOR REDUCER CONNECTOR

TORNILLERIA INCLUIDA HARDWARE INCLUDED

REDUCER CONNECTOR

NOTA 1

PARA REDUCCIONES RECTAS SE DEBERA RESTAR EL ANCHO MAYOR MENOS EL ANCHO MENOR Y DIVIDIR ENTRE 2, POR EJEMPLO SI LA CHAROLA MAYOR MIDE 24" Y LA MENOR 12", LA DIFERENCIA DE ANCHOS SERA DE 6", POR LO TANTO SE DEBERAN SOLICITAR 2 CONECTORES ARR-6.

PARA REDUCCIONES LATERALES SE DEBERA RESTAR EL ANCHO MAYOR MENOS EL ANCHO MENOR, POR EJEMPLO SI LA CHAROLA MAYOR MIDE 24" Y LA MENOR 12" LA DIFERENCIA DE ANCHOS SERA DE 12", POR LO TANTO SE DEBERA SOLICITAR UN SOLO CONECTOR ARR-12, Y UN CONECTOR RECTO.

NOTE 1.-

FOR STRAIGHT REDUCER YOU SHOULD SUBSTRACT THE LARGER WIDTH MINUS SMALLER WIDTH AND DIVIDE BETWEEN TWO, FOR EXAMPLE IF THE LARGER WIDTH IS 24" AND THE SMALER WIDTH IS 12" THE WIDTH DIFFERENCE WILL BE 6", SO YOU SHOULD REQUEST TWO CONNECTORS ARR-6

FOR LEFT & RIGHT REDUCER YOU SHOULD SUBSTRACT THE LARGER WIDTH MINUS SMALLER WIDTH , FOR EXAMPLE IF THE LARGER WIDTH IS 24" AND THE SMALER WIDTH IS 12" THE WIDTH DIFFERENCE WILL BE 12", SO YOU SHOULD REQUEST ONLY ONE CONNECTOR

TODAS LAS DIMENSIONES EN mm (Pulg) ALL DIMENSIONS ARE IN mm (Inch)

TAPA TERMINAL

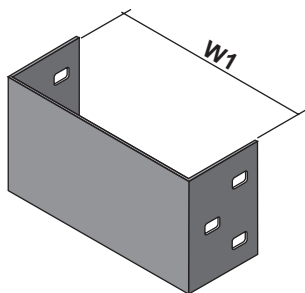

BLIND END

ANCHO DE CHAROLA TRAY WIDTH	W 1
101.6 (4)	106(4.19)
152.4 (6)	157 (6.19)
228.9 (9)	233 (6.19)
304.8 (12)	309 (12.19)
406.4 (16)	411 (16.19)
457.2 (18)	462 (18.19)
508.0 (20)	513 (20.19)
609.6 (24)	614 (24.19)
762.0 (30)	767 (30.19)
914.4 (36)	919 (36.19)

PTR-09-1GI

TORNILLERIA INCLUIDA
HARDWARE INCLUDED

MATERIAL Y ACABADO (VER PAG 20) MATERIAL & FINISHES (SEE PAGE 20)
SUBFIJO P/PERALTE (VER PAG 20) RAIL HEIGHT SUFFIX (SEE PAGE 20)
ANCHO DE LA CHAROLA CABLE TRAY WIDTH
TAPA TERMINAL BLIND END

CONECTOR DE CHAROLA A CAJA

FRAME TYPE BOX CONNECTOR

ANCHO DE CHAROLA TRAY WIDTH	W 1
101.6 (4)	106(4.19)
152.4 (6)	157 (6.19)
228.9 (9)	233 (6.19)
304.8 (12)	309 (12.19)
406.4 (16)	411 (16.19)
457.2 (18)	462 (18.19)
508.0 (20)	513 (20.19)
609.6 (24)	614 (24.19)
762.0 (30)	767 (30.19)
914.4 (36)	919 (36.19)

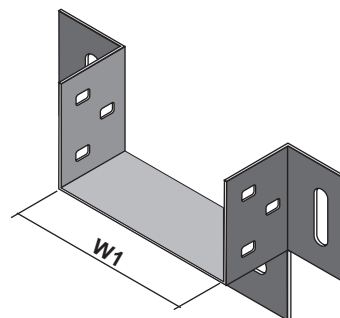

TORNILLERIA INCLUIDA
HARDWARE INCLUDED

ACC-09-1GI

MATERIAL Y ACABADO (VER PAG 20) MATERIAL & FINISHES (SEE PAGE 20)
SUBFIJO P/PERALTE (VER PAG 20) RAIL HEIGHT SUFFIX (SEE PAGE 20)
ANCHO DE LA CHAROLA CABLE TRAY WIDTH
CONECTOR CHAROLA A CAJA FRAME TYPE BOX CONNECTOR

BAJADA PARA CABLE

DROP-OUT

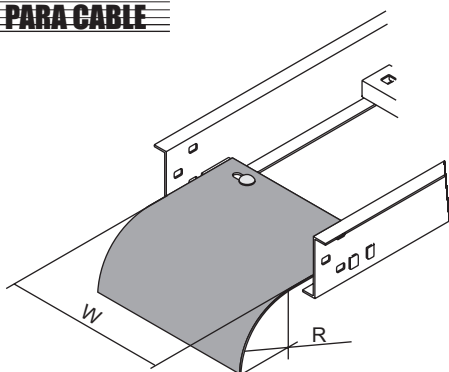

ANCHO DE CHAROLA TRAY WIDTH	RADIO 50.8 (2) RADIUS 50.8 (2)	RADIO 127 (5) RADIUS 127 (5)
101.6 (4)	BC-204	BC-504
152.4 (6)	BC-206	BC-506
228.9 (9)	BC-209	BC-509
304.8 (12)	BC-212	BC-512
406.4 (16)	BC-216	BC-516
457.2 (18)	BC-218	BC-518
508.0 (20)	BC-220	BC-520
609.6 (24)	BC-224	BC-524
762.0 (30)	BC-230	BC-530
914.4 (36)	BC-236	BC-536

BC-509-1GI

TORNILLERIA NO INCLUIDA
HARDWARE NOT INCLUDED

MATERIAL Y ACABADO (VER PAG 20) MATERIAL & FINISHES (SEE PAGE 20)
SUBFIJO P/PERALTE (VER PAG 20) RAIL HEIGHT SUFFIX (SEE PAGE 20)
ANCHO DE LA CHAROLA CABLE TRAY WIDTH
RADIO DE LA BAJADA DROP-OUT RADIUS
BAJADA PARA CABLES DROP-OUT

TODAS LAS DIMENSIONES EN mm (Pulg) ALL DIMENSIONS ARE IN mm (Inch)

BARRERAS SEPARADORAS TRAMO RECTO

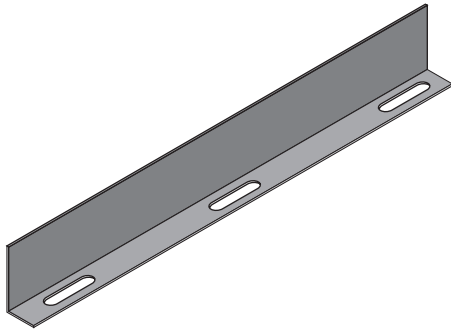

BSCH-3.05-1GI

MATERIAL Y ACABADO (VER PAG 20)
 MATERIAL & FINISHES (SEE PAGE 20)
 SUBFIJO P/PERALTE (VER PAG 20)
 RAIL HEIGHT SUFFIX (SEE PAGE 20)
 LONGITUD DE LA CHAROLA EN METROS
 (DISPONIBLE EN 3.05m Y 3.66m)
 CABLE TRAY LENGHT IN METERS
 (AVAILABLE IN 3.05m AND 3.66m)
 BARRERA SEPARADORA PARA TRAMO RECTO
 STRAIGHT DIVIDER STRIP

INCLUYE 5 CLEMAS CLAMP-112 CON TORNILLERIA
 FIVE HOLD DOWN CLAMP-112 AND HARDWARE INCLUDED

STRAIGHT DIVIDER STRIP

BARRERAS SEPARADORAS CURVAS HORIZONTALES

BSVH-72-1GI

MATERIAL Y ACABADO (VER PAG 20)
 MATERIAL & FINISHES (SEE PAGE 20)
 SUBFIJO P/PERALTE (VER PAG 20)
 RAIL HEIGHT SUFFIX (SEE PAGE 20)
 LONGITUD DE LA BARRERA EN PULGADAS
 (DISPONIBLE EN 48" Y 72")
 DIVIDER STRIP LENGHT IN INCHES
 (AVAILABLE IN 48" AND 72")
 BARRERA SEPARADORA PARA CURVA HORIZONTAL
 HORIZONTAL FITTING DIVIDER STRIP

INCLUYE 3 CLEMAS CLAMP-112 CON TORNILLERIA
 THREE HOLD DOWN CLAMP-112 AND HARDWARE INCLUDED

HORIZONTAL FITTINGS DIVIDER STRIP

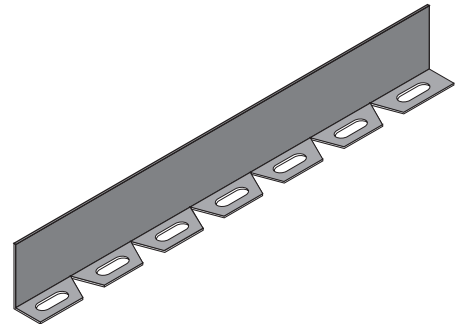

BARRERAS SEPARADORAS CURVAS VERTICALES

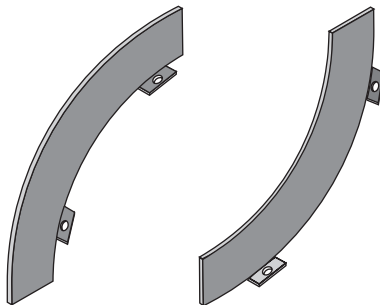

BSVEC-04R08901GI

No DE CATALOGO DE LA PIEZA A LA QUE SE COLOCARA LA BARRERA.
 CATALOG NUMBER OF THE VERTICAL FITTING
 BARRERA SEPARADORA PARA CURVA VERTICAL
 VERTICAL FITTING DIVIDER STRIP

INCLUYE CLEMAS CLAMP-112 CON TORNILLERIA
 HOLD DOWN CLAMP-112 AND HARDWARE INCLUDED

VERTICAL FITTINGS DIVIDER STRIP

CINTAS CONDUCTORAS

PARA SU SELECCION Y APLICACION CONSULTE NOM-001-SEDE-1999 ARTICULOS 318-6A Y 318-7, ADEMAS DE NEMA VE-2
 FOR APPLICATION AND SELECTION, SEE NEC CODE 318-6A & 318-7, ALSO NEMA VE-2

BONDING JUMPERS

No DE CATALOGO CATALOG NUMBER	CAPACIDAD CAPACITY	
CC-99NI	600 AMP. MAX.	
CC-9940	1600 AMP. MAX.	
CC-991620	2000 AMP. MAXIMO	

TODAS LAS DIMENSIONES EN mm (Pulg) ALL DIMENSIONS ARE IN mm (Inch)

TAPAS PARA TRAMO RECTO

STRAIGHT COVERS

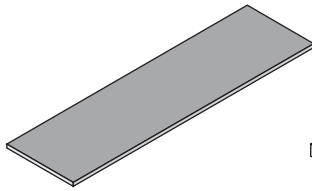

TAPA RECTA TIPO "TR"
FLAT COVER "TR" TYPE

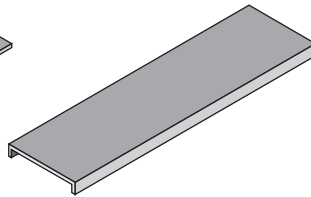

TAPA CON CEJA TIPO "TRC"
FLANGED COVER "TRC" TYPE

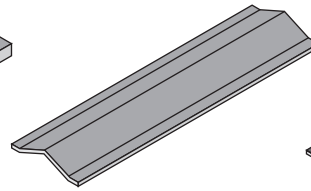

TAPA A DOS AGUAS TIPO "TA"
PEAKED COVER "TA" TYPE

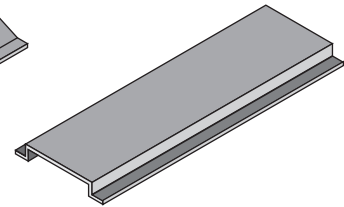

TAPA SOMBRERO TIPO "TSS"
DOMED COVER "TSS" TYPE

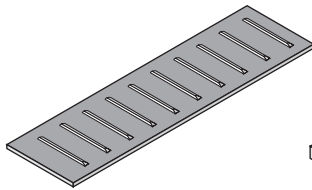

TAPA RECTA CON
VENTILACION TIPO "TRV"
FLAT VENTED
COVER "TRV" TYPE

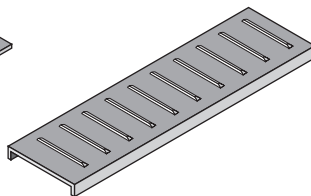

TAPA CON CEJA CON
VENTILACION TIPO "TRCV"
FLANGED AND VENTED
COVER "TRCV" TYPE

LAS TAPAS SE SURTEN EN JUEGOS DE 3 TAPAS DE 1219 mm (4 FT) E INCLUYEN 12 CLIPS DE SUJECION

PARA OTRAS LONGITUDES CONSULTE NUESTRO DEPARTAMENTO DE INGENIERIA

THE COVER IS SUPPLIED IN SET OF 3 COVERS OF 1219 mm (4 FT) 12 COVER CLAMPS ARE INCLUDED

FOR OTHER LENGTHS PLEASE CONSULT OUR TECHNICAL DEPARTMENT

LAS TAPAS PARA ACCESORIOS SOLO SE FABRICAN EN TIPO RECTO E INCLUYEN CLIPS NECESARIOS.

ONLY FLAT TYPE IS SUPPLIED FOR FITTING COVERS AND COVER CLAMP NEEDED ARE INCLUDED

TRCV-CHCB-12-1GI

No DE CATALOGO DE LA PIEZA A CUBRIR CATALOG NUMBER OF THE PRODUCT FOR COVER
TIPO DE TAPA COVER TYPE

CLIPS DE SUJECION PARA TAPAS

PARA CHAROLAS PERFILES TIPO "Z", "CA", "CC", E "I"
FOR PRODUCTS WITH RAIL TYPE "Z", "CA", "CC", & "I"

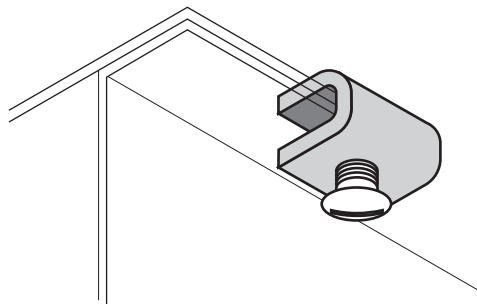

CST-14-GI

MATERIAL Y ACABADO (VER PAG 9)
MATERIAL & FINISHES (SEE PAGE 9)
CLIP NORMAL STANDARD CLAMP

COVER CLAMPS

PARA CHAROLAS PERFILES TIPO "C" Y "CB"
FOR PRODUCTS WITH RAIL TYPE "C" & "CB"

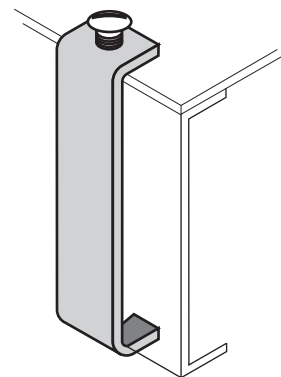

CSTSC-14-1GI

MATERIAL Y ACABADO (VER PAG 9)
MATERIAL & FINISHES (SEE PAGE 9)
SUBFIJO P/PERALTE (VER PAG 9)
RAIL HEIGHT SUFFIX (SEE PAGE 9)
CLIP LARGO LARGE CLAMP

TODAS LAS DIMENSIONES EN mm (Pulg) ALL DIMENSIONS ARE IN mm (Inch)